

REV	DESCRIPTION	DATE
A	Initial Release	12.12.03

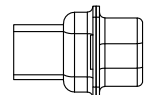
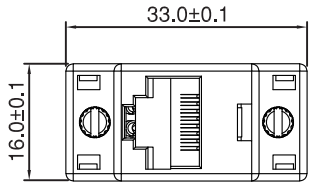
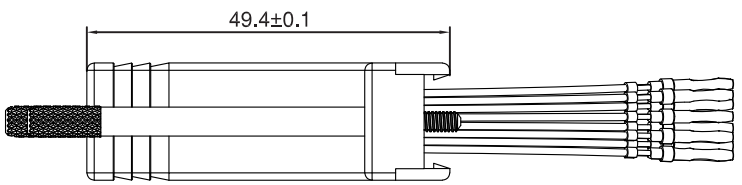
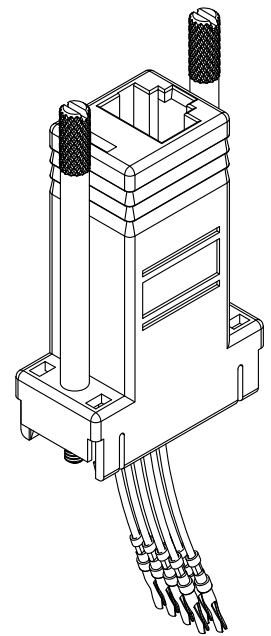
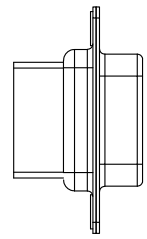
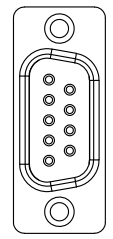
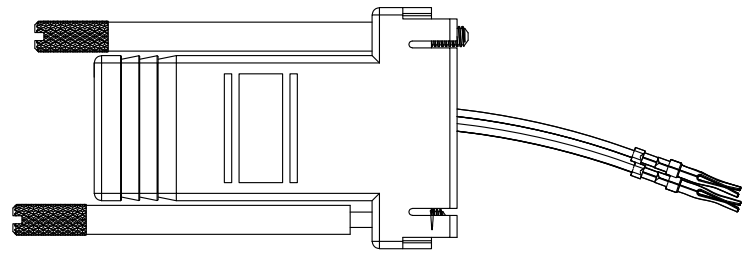

MATERIAL
 PLASTIC : ABS COLOR
 SCREW : NICKEL PLATING THUMB SCREW
 LEAD WIRE: UL1061. 26AWG. 7 STRAND
 CRIMP CONTACTS: COPPER GOLD PLATING
 RJ45 CONTACTS: COPPER GOLD PLATING

PART NO. RJ45/DB9F-XX02

PLASTIC HOUSING COLOR CODE
 BK: BLACK
 GA: GRAY
 GN: GREEN

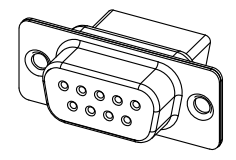

WIRE MAP			Receptacle Crimp Contacts
P1		BLUE	
P2		ORANGE	
P3		BLACK	
P4		RED	
P5		GREEN	
P6		YELLOW	
P7		BROWN	
P8		GRAY	

RJ 45 JACK UL1061

RoHS Compliant

UNLESS OTHERWISE SPECIFIED	UNIT: mm	SCALE: 1:1
	LENGTH	TOLERANCES
45.00		±0.15
6.25		±0.10
25.40		±0.10
35.40		±0.10
ANNEALS	400F	
0.500	ROCKE TRANSFORMER	±0.010
0.500		±0.10

PANSTRONG COMPANY LTD.				DRAWN BY		TOMMY					
				CHECKED		TOMMY					
TITLE:				RJ45 JACK TO D-SUB ADAPTER (Crimp Female)		APPROVED		CAROL			
PART NO:				RJ45/DB9F-XX02		DRAWING NO.					
SCALE		1:1		REV		A		UNIT		mm	